

DIMENSIONS mm (inches)

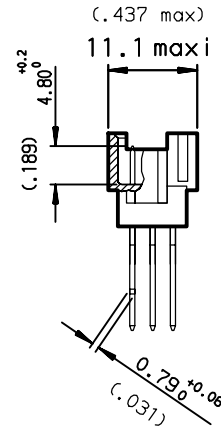

PART NUMBER	8609			79		7		5	
PIN OUT									
rows a-b-c						3		96	
rows a-c						4		64	
NUMBER OF CONTACTS									
TERMINATION									
L = 13.25 ±0.25 (C.521)								1	91
L = 17.25 ±0.25 (C.679)								2	92
L = 20.00 ±0.25 (C.787)								3	93
L = 4.20 ±0.25 (C.165)								short post	94
PERFORMANCE CLASS									
DIN 41612 class 3									4
DIN 41612 class 2									5
DIN 41612 class 1									6
TERMINATION TYPE									
TIN LEAD									000E1
LEAD FREE									E1LF

PCB DRILLING

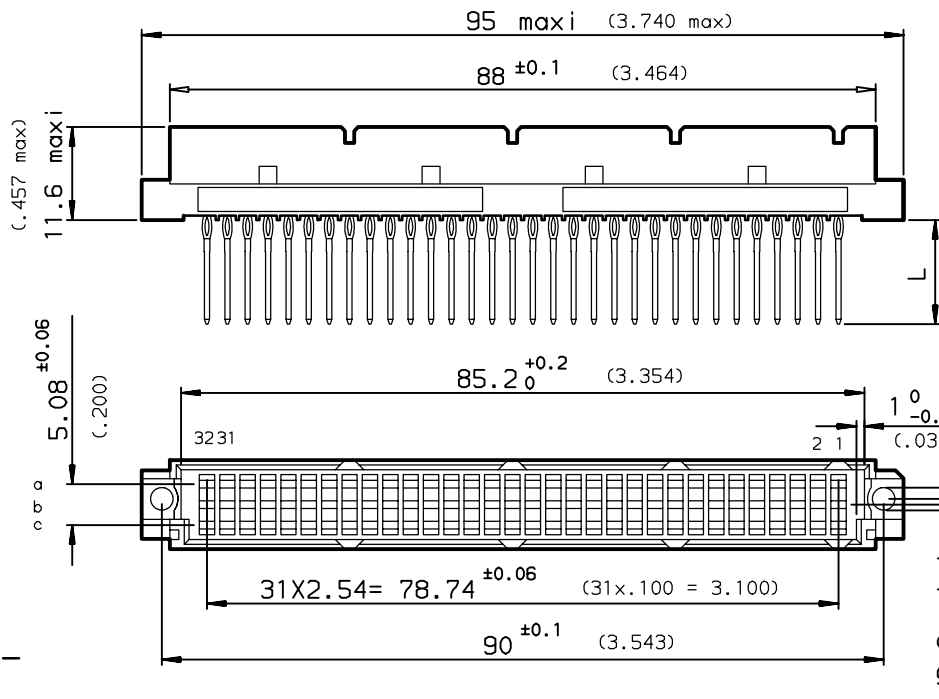
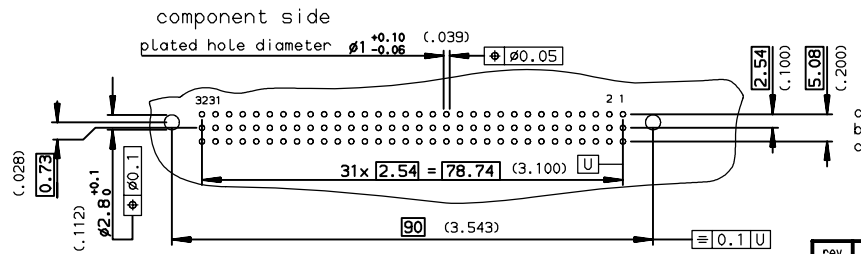

GENERAL CHARACTERISTICS AND ROHS INFORMATIONS:
 SEE DRAWING C-8609-0000C

European Views

www.fciconnect.com		surface ISO 1302	tolerance std ISO 406 ISO 1101	projection	mm
		TOLERANCES UNLESS OTHERWISE SPECIFIED			
Dr	ROUILLARD	1997/10/31	0.X	±0.1	size
Eng	TARON	1997/10/31	0.XX	±0.1	A3
Chr	LEGARE	1997/10/31	0.XX	±0.1	Scale
Appr	LEGARE	1997/10/31	0.XX	±0.1	1.5
		Product family	DIN 8609	Spec ref	ECN L506-0095
		STRAIGHT MALE - STYLE HE 11		dwg no	C-8609-0661
		PRESS FIT		Rev.	E
		catalog no	-	CUSTOMER	sheet 1 of 1

rev	ecn no	dr	date
C	-	ROU	1999/04/22
D	L505-004	JTA	2005/02/11
E	L506-0095	LGO	2006/06/22
-	-	-	-
-	-	-	-
-	-	-	-